

***MAGICSHINE®***

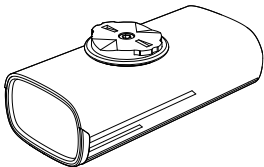

APP PAIRING NAME: M2-B0  
EVO 1300  
USER MANUAL

## **⚠️ WARNING**

1. To prevent inadvertent switching on, please keep the light unit in **lockout mode** before transport or storage.
2. **DO NOT** disassemble, modify, remanufacture, puncture, or damage the device or batteries.



## **IN THE BOX**



EVO 1300



MJ-6508 remote control (incl. strap)



Screw



2mm/3mm hex key



USB-C charging cable



Wahoo mount

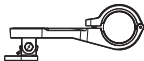

Handlebar out-front mount kit

## QUICK GUIDE

Power button



Long press for 1 second  
to turn on/off



## OPERATING INSTRUCTIONS

### REMOTE CONTROL PAIRING:

**Method 1:** Turn on the light, remove the remote control's battery, and put it back in until the indicator alternately flashes blue to enter pairing mode. Then, close the remote to the light until the indicators on the remote and light unit are constantly blue for 2 seconds, confirming a successful pairing.

**Method 2:** Turn on the light, press and hold the "○" "□" buttons on the remote for about 10 seconds until the indicator alternately flashes blue to enter pairing mode. Then, close the remote to the light until the indicators on the remote and light unit are constantly blue for 2 seconds, confirming a successful pairing.

## REMOTE CONTROL INSTRUCTIONS

### Note:

1. Before first use, please open the remote's battery compartment, remove the insulating spacer, reinsert the battery, then cover the battery compartment, and the indicator on the remote will flash blue.
2. The remote control will enter sleep mode if the light is turned off for more than 48 hours without any operation. Click the light's button to activate it or long-press the light's button to turn it on, and the remote control can work normally.

### REMOTE CONTROL OPERATION:

**ON/OFF:** Press and hold the "○"/"□" button for 1 second

**ADJUST BRIGHTNESS:** Click the "○" button

**CHANGE MODE:** Double click the "○" button

**FLASH MODE:** Double click the "□" button

**FULL OUTPUT MODE (1300LM):** Click the "□" button to switch to the Turbo mode of the high beam and click the "○"/"□" button to return to the previous mode.

### HEADLIGHT BUTTON OPERATION:

**ON/OFF:** Press and hold the button for 1 second

**ADJUST BRIGHTNESS:** When the light is on, click the "☞" button to change the brightness level. The output brightness of the low beam will cycle through Low→Medium→High→Low...The output brightness of the high beam will cycle through from the lower to a higher setting in the App. (Note: There is only one brightness level of the high beam by default. This function is only available when you have customized more than one brightness level of the high beam via Magicshine App.)

**CHANGE MODE:** When the light is on, double click the "☞" button to change between low beam and high beam. (Note: There is only one brightness level of the high beam by default. This function is only available when you have customized more than one brightness level of the high beam via Magicshine App.)

**FULL OUTPUT MODE (1300LM):** When the light is on, click the "☞" button to switch to the Turbo mode of the high beam.

**CHECK BATTERY LEVEL:** Click the button

**LOCKOUT:** When the light is off, press and hold the button for 3 seconds to enter lockout mode.

**UNLOCK:** When in lockout mode, press and hold the button for 3 seconds or charge the light.

## CHARGING / BATTERY INDICATOR

Standard charging time approx. 4.5 hrs (5V 1A)

Charging: Flashing red

Fully charged: Constant green



## BATTERY INDICATOR

When the light is off, click the button to display the remaining battery level for 3 seconds.

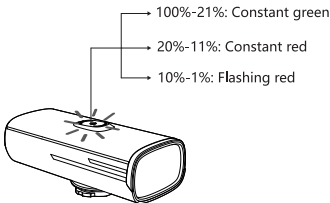

## OUTPUT / RUNTIME

<b>LOW BEAM</b>	LOW	100LM	15H
	MEDIUM	300LM	6H
	HIGH	650LM	3.1H
<b>HIGH BEAM</b>	TURBO	1300LM	2H
<b>FLASH MODE</b>	DAY FLASH	1300~0LM	9H
	NIGHT FLASH	1300~300LM	4H

\* All data are measured in accordance with ANSI/NEMA FL 1-2009. The test was conducted at a temperature of 25°C and a wind speed of 25 km/h. The runtime may vary depending on external temperature and ventilation conditions, and these deviations may affect the result of testing.

\*The Day flash and Night flash can only be accessed through the remote control.

# HOW TO INSTALL

## 1. INSTALL UNDERNEATH THE STANDARD HANDLEBAR

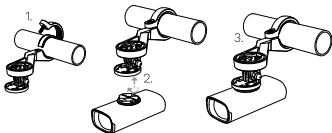

## 2. REMOTE CONTROL MOUNTING

